



Ula Love Doughty Carousel Theatre Technical Specifications

UT Department of Theatre • 206 McClung Tower • Knoxville, TN 37996

B A C K G R O U N D I N F O R M A T I O N

The Ula Love Doughty Carousel Theatre is an arena-style theatre located in the center of the University of Tennessee's Knoxville campus. The Carousel Theatre was founded by interested members of the Knoxville Community together with the University of Tennessee Theatre staff as a self-supporting civic and educational enterprise. The first performances were held in a cross-shaped tent on the current site in the summer of 1951. Public response led to plans for a year-round program in a permanent structure designed for arena staging. The unique design facility incorporated a unique set of design features including removable wall panels to allow for open-air performances during the summer. Contributions and a \$35,000 loan from the University permitted the erection of the principle structure in the Spring of 1952. Net earnings during the ensuing four years provided for the foyer, booth, dressing wing, paid off the original debt and provided for a \$75,000 plant investment.

G E N E R A L I N F O R M A T I O N / C O N T A C T S

MAILING ADDRESS

Ula Love Doughty Carousel Theatre
206 McClung Tower
1115 Volunteer Blvd.
Knoxville, TN 37996

PHYSICAL & SHIPPING ADDRESS

Ula Love Doughty Carousel Theatre
1704 Andy Holt Ave.
Knoxville, TN 37916-3702

PRODUCTION MANAGER

SUSAN L. McMILLAN
SMCMILL9@UTK.EDU

TECHNICAL DIRECTOR

JASON FOGARTY
JFOGARTY@UTK.EDU

OTHER NUMBERS

865.974.5161
TICKETS

865.974.3447
BOX OFFICE

865.974.6063
BOOTH

T R A V E L & P A R K I N G

Keith Kirkland, General Manager • o.865.974.5659 • f.865.974.4867 • generalmanager@utk.edu

DRIVING WEST ON I-40

Take Exit 387: 17th Street/Western Ave (Use caution, this is a cloverleaf-type exit)
 Merge to the far right lane on the exit.
 At the light, Turn right onto 17th Street, NW
 Proceed directly ahead through 3 red-lights and a stop sign (Caution: oncoming traffic does NOT stop)
 At the fourth light (Cumberland Avenue) 17th Street will become Melrose Place—continue straight
 Melrose Place will end at Andy Holt Ave.
 Turn Right onto Andy Holt Ave.
 Turn Left *immediately* into Staff Lot 23.
 Go to the end of the parking lot as you enter and turn left.
 The theatre is directly ahead.

DRIVING EAST ON I-40

Take Exit 387: TN-62 towards 17th St/Western Ave.
 Continue straight as you merge onto Dale Ave.
 Merge to the far right lane.
 At the light, turn Right onto 17th Street, NW
 Proceed directly ahead through 2 red-lights and a stop sign (Caution: oncoming traffic does NOT stop)
 At the third light (Cumberland Avenue) 17th Street will become Melrose Place—continue straight
 Melrose Place will end at Andy Holt Ave.
 Turn Right onto Andy Holt Ave.
 Turn Left *immediately* into Staff Lot 23.
 Go to the end of the parking lot as you enter and turn left.
 The theatre is directly ahead.

DRIVING NORTH ON ALCOA HWY
 (FROM THE AIRPORT)

Take the Exit Marked US-11/Kingston Pike/US-70
 At the light, turn Right onto Kingston Pike
 Go over and under the Railroad tracks and turn Right at the next light onto Volunteer Blvd
 At the next light, turn Left at the next Stop Light onto Andy Holt Ave
 Follow Andy Holt Avenue until just before it Dead Ends
 Turn Right into Staff Lot 23.
 Go to the end of the parking lot as you enter and turn left.
 The theatre is directly ahead.

PARKING

Parking is available in the lot directly adjoining the Theatre (listed as Staff Lot 23 on campus maps). Parking permits must be acquired by the Production Manager at least seven (7) days prior to the event and cost \$5 per vehicle space occupied per day. Spaces in this lot are extremely small and larger vehicles (i.e. large vans, duelies, box trucks, etc.) may require more than one space.

**Failure to obtain permits or improper display will result in ticketing by the University of Tennessee.
 The Clarence Brown Theatre assumes NO responsibility for parking violations.**

Due to limitations of space on campus, parking is a constant issue. Please make arrangements prior to arrival for all your parking needs. Additional parking can be arranged with sufficient notice. Advance notice is critical for large vehicles such as busses and/or trucks.

Shore Power: The Facility is not equipped to provide shore power.

LOADING DOCK

The Carousel Theatre does not have a loading dock of any sort and does not directly abut the parking lot. The dressing rooms are most easily accessed via a short stairway on the rear exterior of the building. Smaller items may be loaded into the main space via a series of sidewalks and personnel doors. Items which cannot fit through a standard door may be accommodated by opening one of the exterior walls to the facility. In addition to opening the wall, the seating units directly next to this wall must be disassembled, moved, and later put back. Because of the costs inherent to this complicated move we highly encourage groups to restrict themselves to loading in items which will fit through standard doors. The maximum guaranteed size of the opening when the wall is removed is 8' high x 16' wide. A lift gate or ramp is advised for all truck loading/unloading and will not be provided by the Facility.

T H E A T R E S P E C S

The Ula Love Doughty Carousel Theatre is an intimate arena style venue. All seats in this facility are movable, and although seating configurations are somewhat restricted by fire codes, seating may be scaled to meet the needs of almost any event in the facility. Renting Organizations may request a specific configuration be preset or alternately make arrangements to setup the seating with their own personnel under the guidance of the Rental Supervisor. If any seating platforms or walls need to be reconfigured, Clarence Brown personnel must perform the seating alterations. **Reconfiguration of seating platforms/walls will be allowed ONLY if sufficient time is available for reconfiguration before and restoration following the event.** Any labor required for reconfiguration and restoration will be billed to the Renting Organization. All configuration changes must be approved by and are at the sole discretion of the Clarence Brown Theatre's Production Manager.

SEATING

FULL ARENA MAXIMUM	ACCESSIBLE SEATING
400	7

GENERAL STAGE DIMENSIONS

LOWER RING	AVG. RING DEPTH	AVG. RING RISE
31'-4"	2'-10 1/2"	6"

ADDITIONAL INFORMATION

Stage Floor: Cement slab painted gloss black.

Traps: None

Pit: None

Dance Floor: None

Backstage Crossover: A narrow crossover is located between the audience seating and exterior of the building. This crossover varies in width from 1' to 3'. While this crossover is visually masked behind the audience, fire code precludes masking in front of any fire exits so those zones must be crossed in-view. This crossover is not sound-proofed in any way.

A U X I L I A R Y S P A C E S

REHEARSAL/WARM-UP ROOMS

No dedicated rehearsal or warm-up facility is available. If available, the Lab Theatre or a space in the Clarence Brown Theatre (both facilities located adjacent to the Carousel) may be rented as rehearsal or warm-up space. These facilities are, however, heavily booked and will be billed as Auxiliary Facilities.

GREEN ROOM

The Green Room [105] is located down the hallway located between 10 & 11 o'clock (6 o'clock being the Lobby of the building). The room is approximately 10'-0" x 12'-0" and provides access to the 2 Dressing Rooms.

Amenities: Small refrigerator, microwave, coffee pot, some counter space, chairs and a sofa.

DRESSING ROOMS

Principle Dressing Rooms: No specific Principle Room is available.

Chorus Dressing Rooms: Two small Dressing Rooms accommodate 4-8 people. [106] & [107]

Amenities: A single Men's and Women's Restroom is located just outside the Green Room. Each dressing room includes a sink, shower, small rack for clothes, and shelving unit. No wardrobe facilities/equipment are available in this building; however, subject to availability, arrangements can be made to use the facilities/equipment available at the Clarence Brown Theatre next door.

R I G G I N G

The Carousel Theatre is not designed for rigging or flying of any type. Small items such as chandeliers may be spot rigged with the prior approval of the Technical Director.

L I G H T I N G

The Carousel Theatre does not maintain a Reparatory Lighting Plot for theatrical lighting purposes. Lectures, presentations, and other similar events may elect to use the "House Plot" rather than hire a lighting designer for the event. The House Lighting Plot includes a general wash on the stage, and up to two podium specials. The following chart outlines the options and fees associated with using the House Plot.

DESCRIPTION	SET UP FEE	USAGE PER DAY
House and Work Lights	none	included
House Plot	\$250.00	\$25.00

Events requiring more intricate lighting needs will require a lighting designer and will incur additional labor charges for the hang, focus, and strike of the lighting equipment as well as equipment rental and usage fees. In-house equipment availability is dependent upon the needs of the Clarence Brown Theatre Company. Lighting designs which exceed the current in-house capabilities of the Clarence Brown will be filled out with rented gear and billed at cost for this equipment. A cost and availability estimate for a particular lighting design can be provided. To receive a cost and availability estimate, a completed light plot (printed, AutoCAD, and/or VectorWorks versions are acceptable) and paperwork (LightWright or equivalent) should be submitted to the Production Manager. Cost estimates should be returned to the Renter within one week.

POWER AND TIE-INS

400A 120/208V, Three phase available in the Patch Bay/Dimmer Room [102]
 208V Power for Intelligent Fixtures; 1 Cir. located near the Dressing Room Hallway

DIMMING & DISTRIBUTION

48 2.4kW Teatronics Dimmers	116 Circuits w/ Hard Patch
48 2.4kW ETC Dimmers w/ Built-in Patch	4 dedicated Multi Runs

CONTROL

ETC Ion
 Dimmable house lighting requires the use of at least 2 of the 48 dimmers.
 No DMX built-in DMX distribution is available.

EQUIPMENT

In-house equipment availability is dependent upon the needs of the Clarence Brown Theatre Co. Rentals which exceed the capabilities of the CBT will be filled with rented gear and billed at cost for this equipment.

S O U N D

The Carousel Theatre is a very “live” small sized venue and maintains a permanently installed playback and amplification system for the main house. Monitor systems and a wide variety of additional sound equipment are available for rental but are installed specifically for the event in question. In-house equipment availability is dependent upon the needs of the Clarence Brown Theatre Co. Rentals which exceed the capabilities of the Clarence Brown Theatre will be filled with rented gear when possible and billed at cost for this equipment. As in-town rental sound equipment is somewhat limited, sound intensive shows should submit their sound system requirements as early as possible. All due effort will be made to fulfill sound package requests at spec, but no guarantee is made or implied. Please be aware that power and equipment for rock-concert style sound amplification is not available.

CONTROL

Mix Position: Permanent closed booth [100] located next to the foyer [199].

Mixing Console:

Soundcraft Series II 32x8x2x1 Analog Console
 Mute groups and scene-based mute memory, full meter bridge

COMMUNICATIONS & LISTENING ENHANCEMENT

Hearing Assist System:

Monitor/Paging System:

Wired Production Communication:

Wireless Production Communication: None available.

Comm. Headset Locations:

SOUND REINFORCEMENT & DESIGN

The Clarence Brown Theatre has a wide range of equipment which includes an array of playback equipment, wired mics, wireless mics, speakers, monitors, amplifiers, etc. A full equipment inventory and pricing is available upon request.

In addition to its equipment resources for sound reinforcement and playback, the Clarence Brown Theatre can also provide assistance with Sound Design. A small office/work area is equipped with P4 & monitors, keyboard station, and equipment which easily supports mobile recording, etc.

W A R D R O B E

Irons, ironing boards, steamers, a washer, a dryer, and portable costume racks are available upon request please contact Production Management prior to your arrival to make arrangements. There are permanent racks with hangers in each of the dressing rooms.

Quick change booths can be created backstage as necessary as long walkways and fire exits are kept clear.

T H E A T R E D R A W I N G S

Full scale drawings of the facility are available in the following formats:

PDF¹: 2-D Groundplan; 2-D Section

VectorWorks 10: 2-D Groundplan; 2-D Section

VectorWorks 11: 2-D Groundplan; 2-D Section; 3-D Model

VectorWorks 12: 2-D Groundplan; 2-D Section; 3-D Model

AutoCAD²: 2-D Groundplan; 2-D Section

ROOM NUMBER AND BUILDING SCHEMATIC

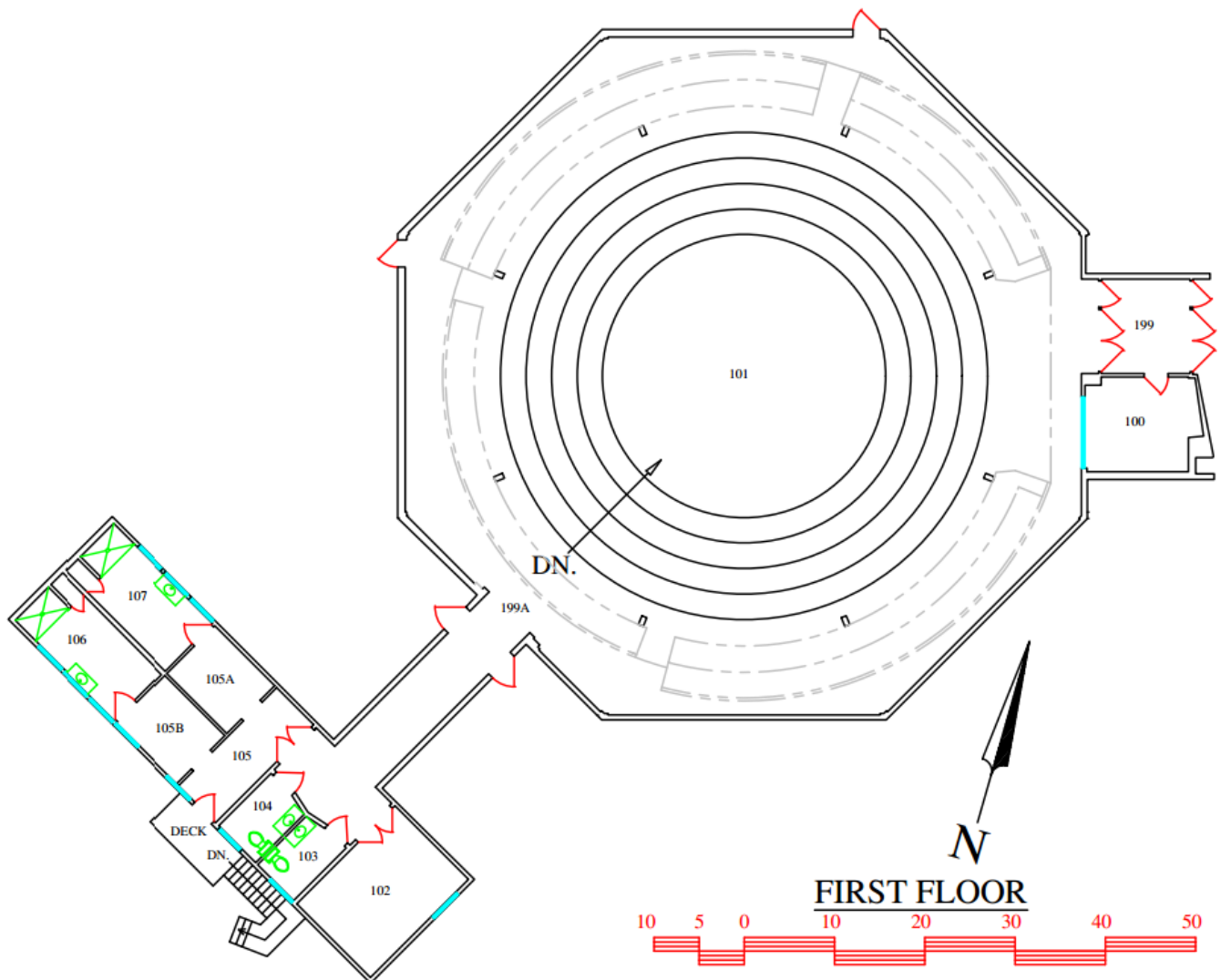

¹ The newest version of Adobe Acrobat Reader may be required. This is available as a free download from www.adobe.com.

² The CBT operates using VectorWorks and provides AutoCAD drawings as a service to our users. Whenever possible the CBT prefers drawings and information in VectorWorks format.

STAGE PLAN VIEW

NOTE: This image, while in scale, is not in 1/4" scale as indicated on the image itself.

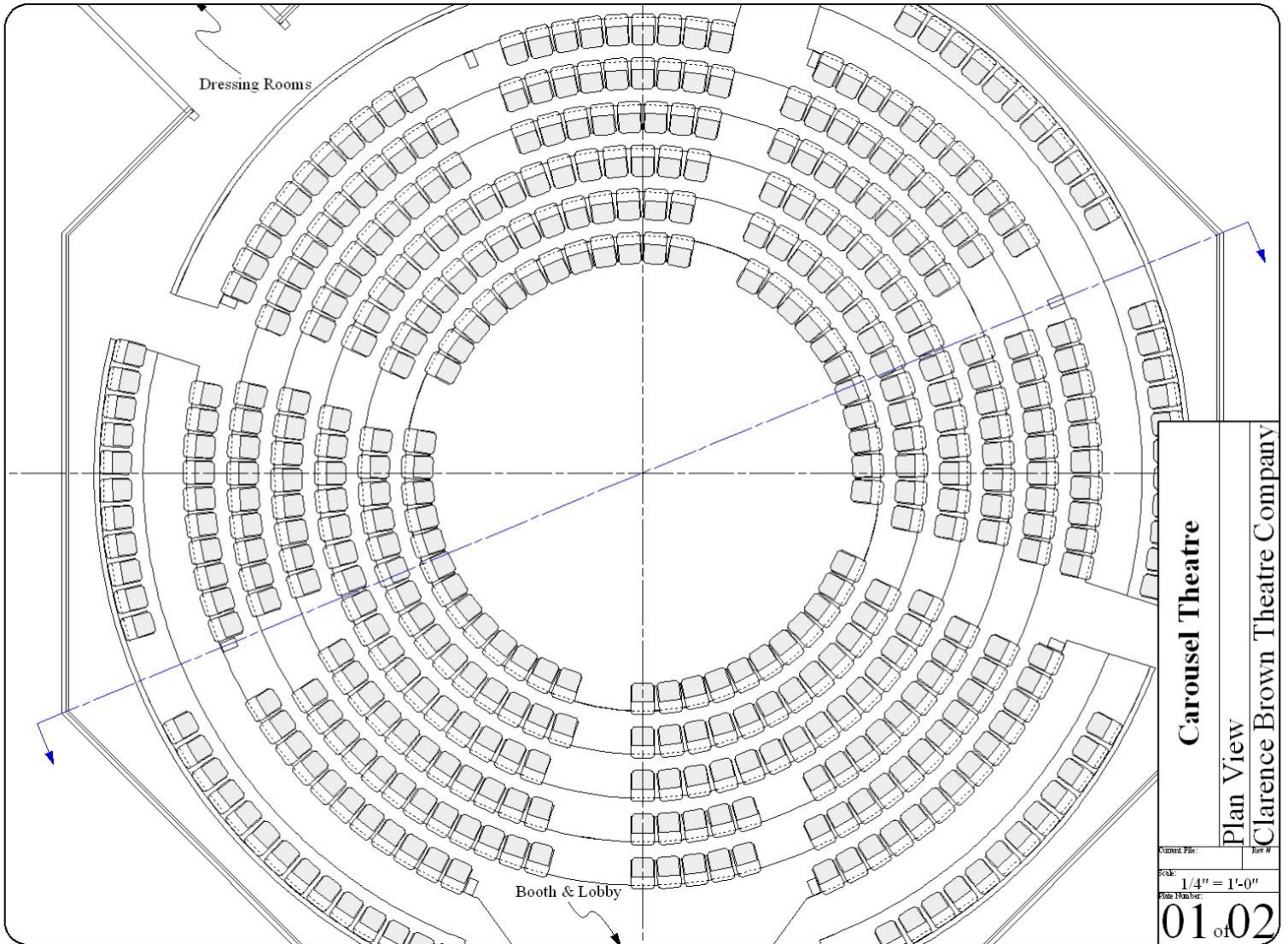

THEATRE SECTION VIEW

NOTE: This image, while in scale, is not in 1/4" scale as indicated on the image itself.

